

AIRFLOW

STATION+

INSTRUCTIONS FOR USE

Table of contents →







1. BEFORE USE	2	4. CLEANING & DISINFECTION.....	13
1.1. INTENDED USE	3	4.1. GENERAL CLEANING	13
1.2. INTENDED USER	3	4.2. WATER LINE CLEANING & DISINFECTION.....	13
1.3. CONTRAINDICATIONS	3	5. MAINTENANCE & TROUBLESHOOTING	17
1.4. GENERAL PRECAUTIONS.....	3	5.1. TROUBLESHOOTING	17
1.5. COMPATIBILITY	4	5.2. TO CONTACT EMS SERVICE SUPPORT	17
2. INSTALLATION.....	5	6. SUSTAINABILITY.....	17
2.1. EQUIPMENT INCLUDED IN THE BOX	5	6.1. DISPOSAL OF WASTE PARTS.....	17
2.2. STEP-BY-STEP CART ASSEMBLY	6	6.2. SUSTAINABLE DESIGN	17
2.3. STEP-BY-STEP DEVICE INSTALLATION.....	7	7. WARRANTY	18
3. DEVICE USE	9	8. TECHNICAL DESCRIPTION	18
3.1. INTERFACES	9	8.1. SYMBOLS	18
3.2. PREPARATION BEFORE FIRST USE	9		
3.3. WATER SUPPLY	10		
3.4. STORAGE	12		

1. BEFORE USE

CONGRATULATIONS!

You are now the owner of this new EMS device!

Please read the instructions carefully before use →

-  DO NOT open the WATER Bottle Shelf System. There are no serviceable parts inside.
-  DO NOT modify this equipment and/or any of its accessories. No modification of any part of this medical device is allowed.
-  If any serious incident occurs that is directly or indirectly related to the device, report it immediately to the manufacturer and to the competent authority of your country and of where the patient is established (if different).
-  Turn off the water inlet when not in use. The device is not equipped with Aquastop and the EG-110 water hose may disconnect or leak: risk of flooding.



- The instructions for use of the device are provided in electronic format. However, if you want a hard copy, you can request one free of charge on our website, by telephone or in writing, and receive it within 7 days.
- The instructions for use for the **AIRFLOW STATION+** are available for download in PDF format at <http://www.ems-instruction.com> using the Product/Key Code DW-048A.
A PDF reader is required and, in case of need, it can be downloaded from the same web site.
- It is essential to first read and understand all the instructions for use before operating the device and using the related accessories.
- We recommend that you visit our website regularly to consult and/or download the latest version of the instructions for use of your device at <http://www.myems.dental>
- Please contact EMS technical support or your local EMS representative for further information and support.
- Always keep this documentation close at hand.

The **AIRFLOW STATION+** instructions for use are supplementary to FB-618 for the AIRFLOW Prophylaxis Master and FB-621 for the AIRFLOW One. The instructions for use for the AIRFLOW Prophylaxis Master and AIRFLOW One are available for download in PDF format at <http://www.ems-instruction.com> using the Product/Key Code FT-229 and FT-230 respectively.

AIRFLOW STATION+ DW-048A

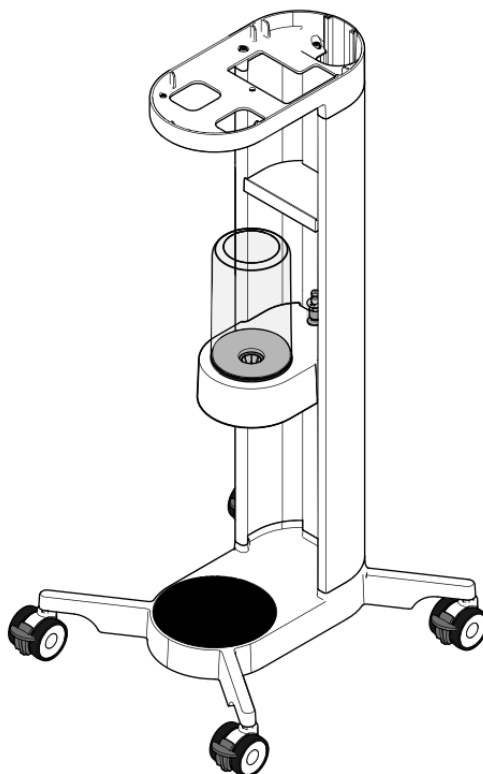

1.1. Intended Use

The AIRFLOW STATION+ is intended to be used only for the retention of the EMS AIRFLOW Prophylaxis Master or the EMS AIRFLOW One.

The AIRFLOW STATION+ is intended to supply water to the EMS AIRFLOW Prophylaxis Master or the EMS AIRFLOW One unit via the WATER Bottle Shelf System.

1.2. Intended User

Refer to intended user as qualified in the Instructions for Use for the EMS AIRFLOW Prophylaxis Master or the EMS AIRFLOW One units.

1.3. Contraindications

The use of the AIRFLOW STATION+ does not add any additional contraindications to those stated in the Instructions for Use for the EMS AIRFLOW Prophylaxis Master or the EMS AIRFLOW One units.

1.4. General Precautions

 DO NOT sit or step on the device.

 DO NOT place a load on the device greater than 10kg

1.5. Compatibility

The following devices and parts combinations are compatible with the AIRFLOW STATION+ but are not provided:



AIRFLOW Prophylaxis
Master (FT-229)



AIRFLOW One
(FT-230)



⚠ DO NOT use with other devices than the EMS AIRFLOW Prophylaxis Master (FT-229) or AIRFLOW One (FT-230). This cart (the device) retainer is NOT intended to host anything else than these listed compatible devices.

NIGHTCLEANER Bottle
(EG-120)



CLIP+CLEAN
(EL-655)



AIR hose
(EH-142)

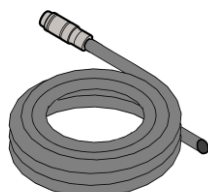

Power Cord



⚠ Be aware
The use of cables and accessories other than those supplied by EMS may negatively affect EMC performance. Use only parts supplied by EMS

2. INSTALLATION

2.1. Equipment included in the box

 Check contents for any damage that may have occurred during transportation.



Quick Guide and Safety Sheet

Assembly instructions and provides link to eIFU download for FB-637

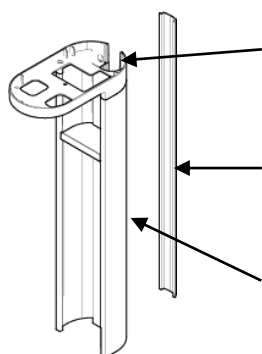

Retainer

Holder for EMS unit with hole for screw fixation and Torx key holder

Slider

Slider for cable cavity

Column with small shelf

Central support and small shelf for storage of powder chambers or bottles



Wheel Base

With wheels and foot grip attached



Cable Tidy

1 x Cable tidy sleeve for containment of air and power cables

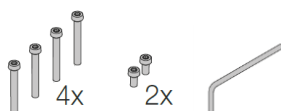

Assembly Kit

4 x Long Screws – M5 x 40
2 x Short Screws – M5 x 16
1 x T20 Torx Key Tool



Water Bottle Shelf System

with air filter EL-599 installed
EL-656



WATER bottle

1 x EG-121

2.2. Step-by-Step Cart Assembly

The device must be placed on a secure and flat surface (with a maximum slope of 5 degrees) during assembly.

The following assembly steps are as per the Assembly Quick Guide FB-637 provided with your AIRFLOW STATION+.

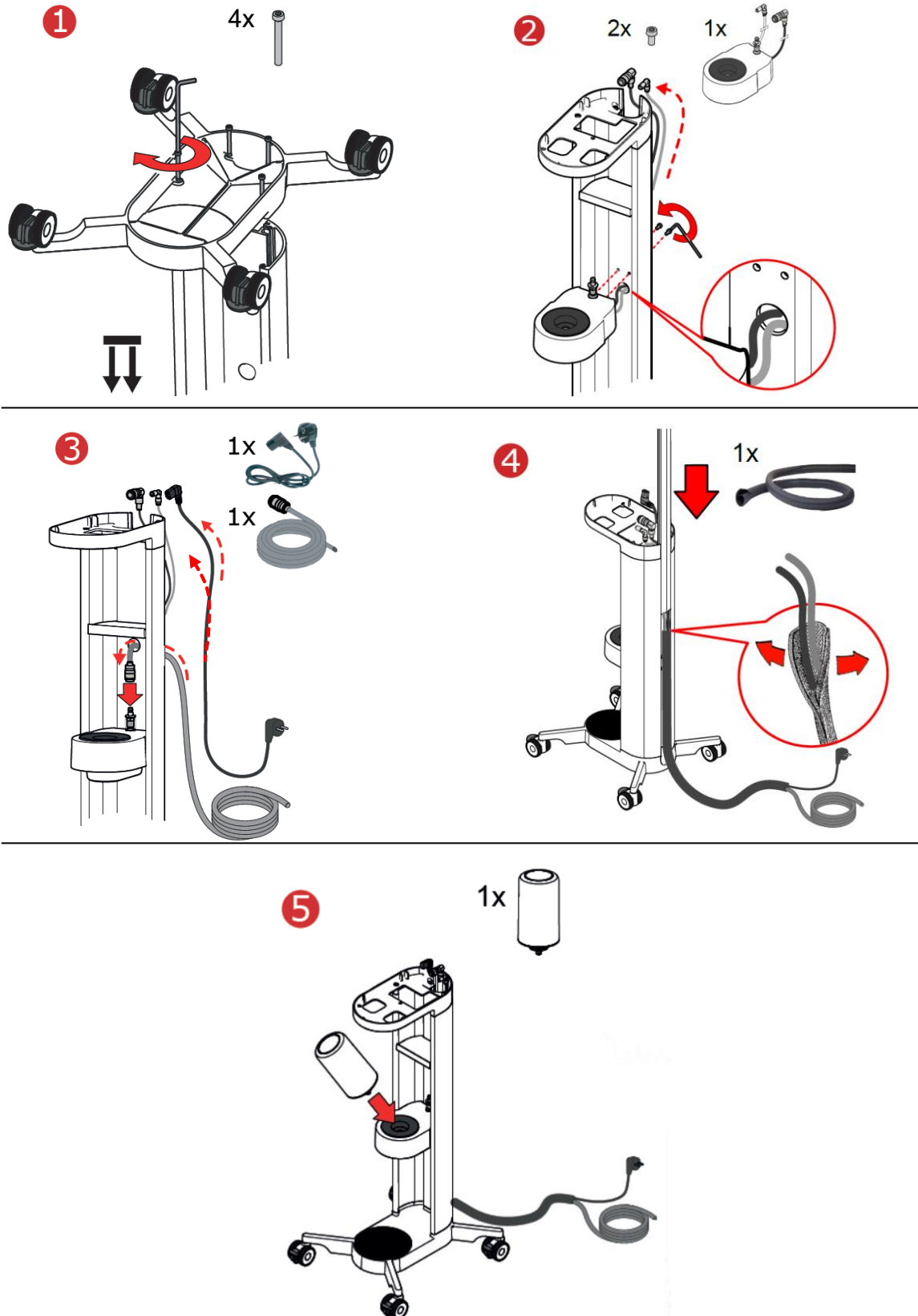

2.3. Step-by-Step Device Installation

1. Remove the Master screw from your EMS AIRFLOW Prophylaxis Master or AIRFLOW One device. Keep this screw for later fixation to the cart retainer.

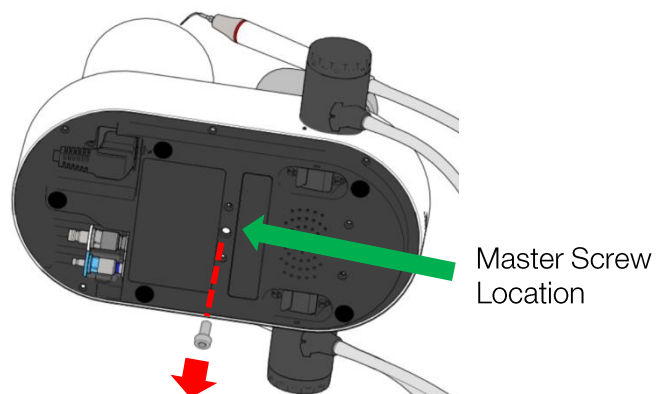

2. Place your EMS AIRFLOW Prophylaxis Master or AIRFLOW One device on the retainer, and tilt it to reveal the Water, AIR and Power connections.

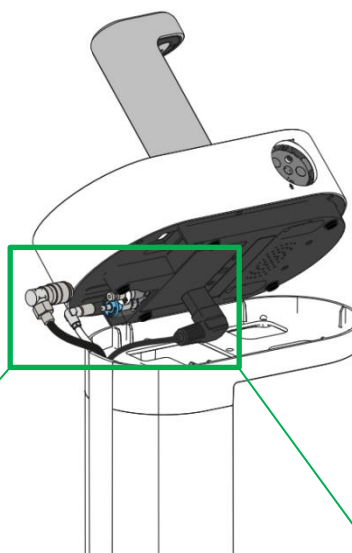

3. Connect the following in sequence:
 1. WATER Connector
 2. AIR Connector
 3. Power Cable

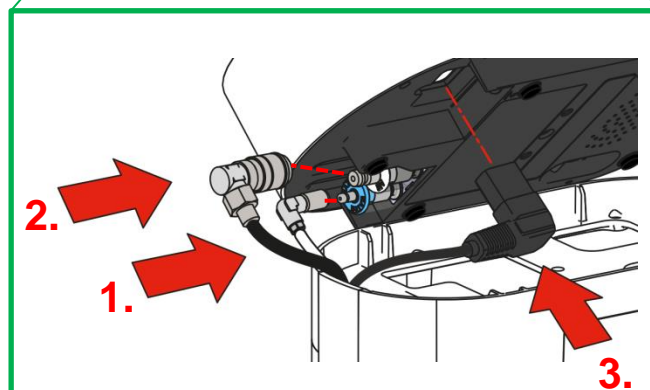

- Using the Master Screw, secure the EMS AIRFLOW Prophylaxis Master or AIRFLOW One device to the Retainer.

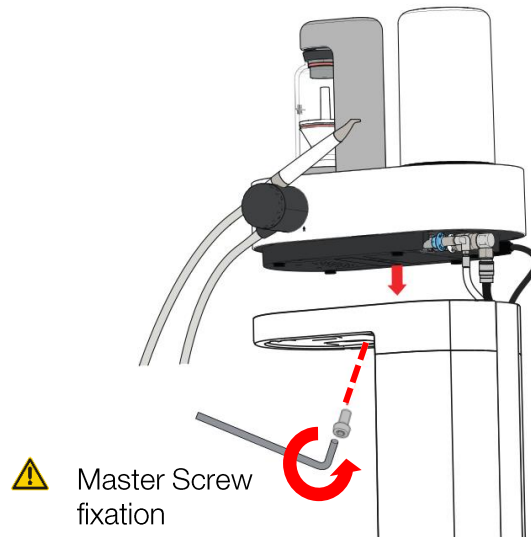

- The torx key tool can be stored using the magnets underneath the retainer.

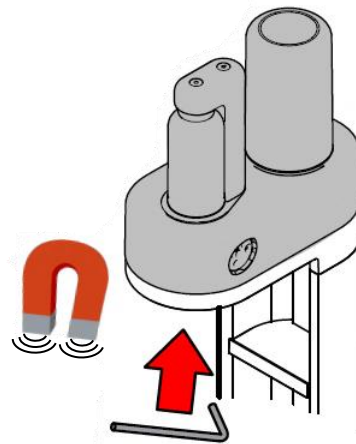

- Install and fix the Air Hose (EH-142) in the dental cabinet. Ensure AIR connection at the Water bottle shelf (EL-656).

⚠ Ensure the input air pressure is between 4.5 - 7bar.

- Plug in the power cable into an available socket.

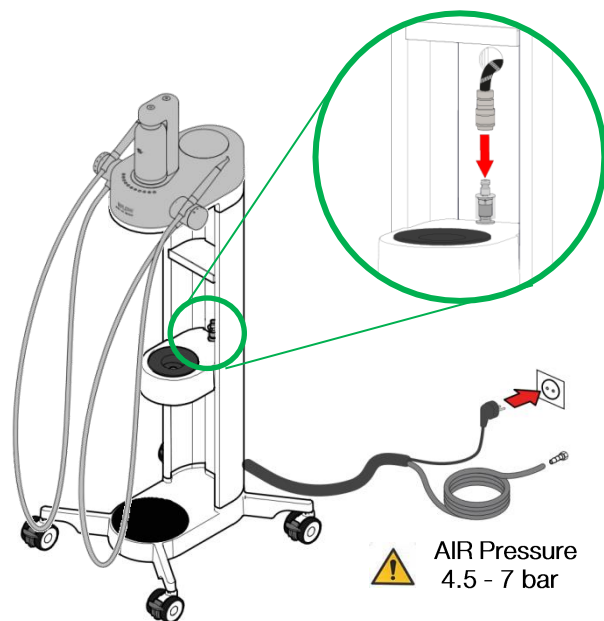

⚠ **Be aware**

The use of cables and accessories other than those supplied by EMS may negatively affect EMC performance. Use only parts supplied by EMS

3. DEVICE USE

! Ensure that the Installation steps are completed before system use to ensure EMS AIRFLOW Prophylaxis Master or the AIRFLOW One device unit cannot be removed without the use of a tool.

3.1. Interfaces

The AIRFLOW STATION+ is design for easy manoeuvrability. The carts allow for 360° movement and have a full 4 wheel braking system.

The storage shelving is designed to contain spare powder chambers, and EMS powder bottles.

The AIRFLOW STATION+ allows for complete independence from a water network supply. Simply fill the water bottle and connect onto the Water Bottle Shelf.

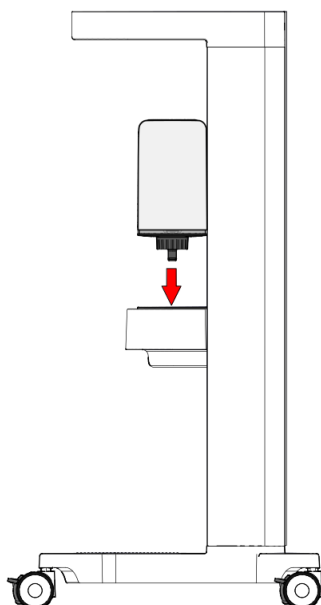

! Refer to the instructions for use of the EMS AIRFLOW Prophylaxis Master or the EMS AIRFLOW One units for more information on their usage.

3.2. Preparation Before First Use

1. Perform a cleaning and rinsing cycle as directed in Section 4 Cleaning and Disinfection.
2. Fill the WATER Bottle and connect into the cart water bottle shelf

! Refer to the Instructions for Use of your EMS AIRFLOW Prophylaxis Master or AIRFLOW One device for any further actions before first patient use.

3.3. Water Supply

The WATER Bottle can be used with your EMS AIRFLOW Prophylaxis Master or AIRFLOW One device under the following configurations

AIRFLOW Prophylaxis Master - FT-229

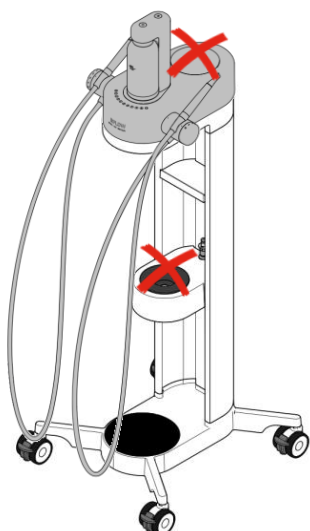

- ✗ PIEZON TREATMENT – NO WATER
- ✗ AIRFLOW TREATMENT – NO WATER

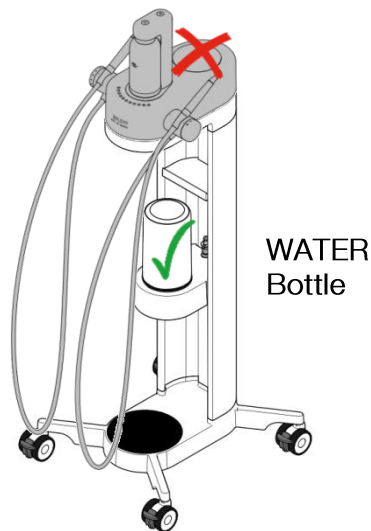

- ✓ PIEZON TREATMENT – WATER Bottle
- ✓ AIRFLOW TREATMENT – WATER Bottle

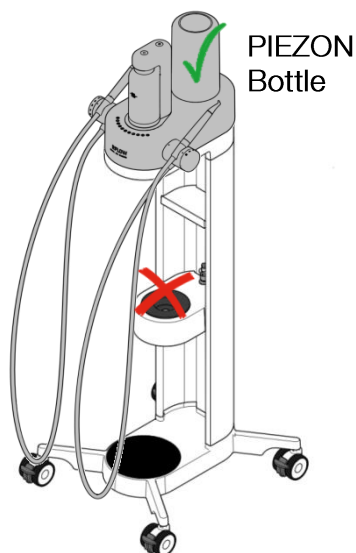

- ✓ PIEZON TREATMENT – PIEZON Bottle
- ✗ AIRFLOW TREATMENT – NO WATER

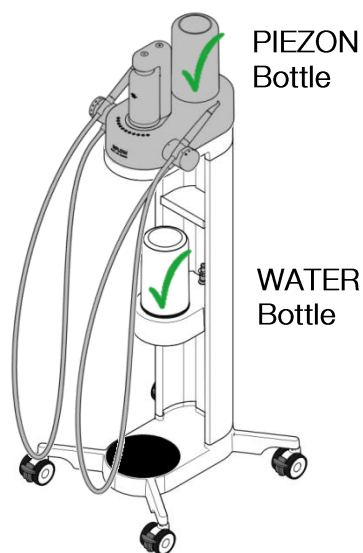

- ✓ PIEZON TREATMENT – PIEZON Bottle
- ✓ AIRFLOW TREATMENT – WATER Bottle

AIRFLOW One - FT-230

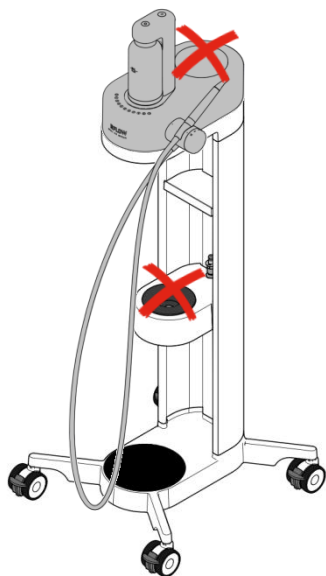

✗ AIRFLOW TREATMENT – NO WATER

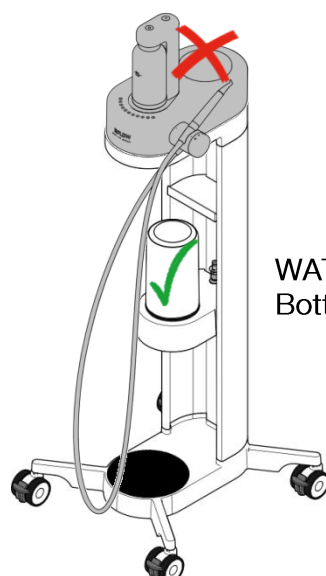

WATER
Bottle B

✓ AIRFLOW TREATMENT – WATER Bottle B

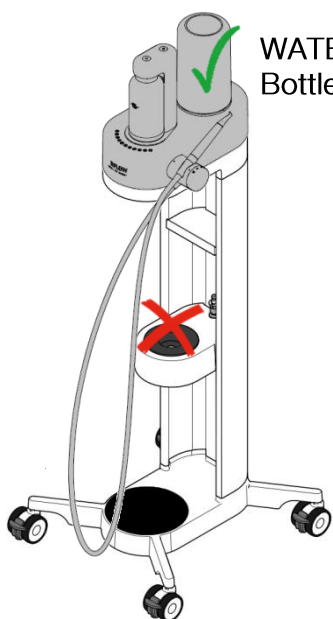

WATER
Bottle A

✓ AIRFLOW TREATMENT – WATER Bottle

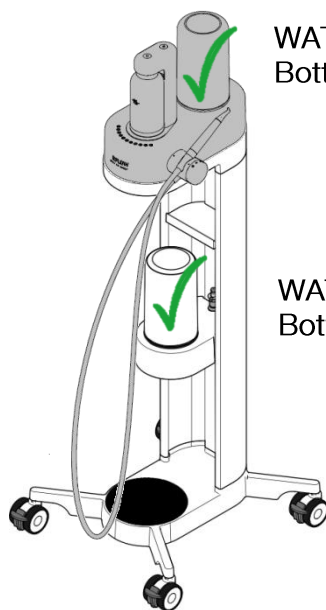

WATER
Bottle A

WATER
Bottle B

✓ AIRFLOW TREATMENT – WATER Bottle A

WATER bottle cleaning:



WATER Bottle
(EG-121)

⊘ Do not sterilize the WATER bottle and its nozzle cap by steaming or dry thermal reprocessing. Use only ambient temperature active disinfectant and cleaning agents.

3.4. Storage

One of the CLIP+CLEAN provided with the EMS AIRFLOW Prophylaxis Master and AIRFLOW One device can be used to shield the bottle receptacle when the device is not in use.

⚠ The CLIP+CLEAN should be previously cleaned and disinfected before use as non-disinfected CLIP+CLEAN may contaminate the device.



CLIP+CLEAN
(EL-655)

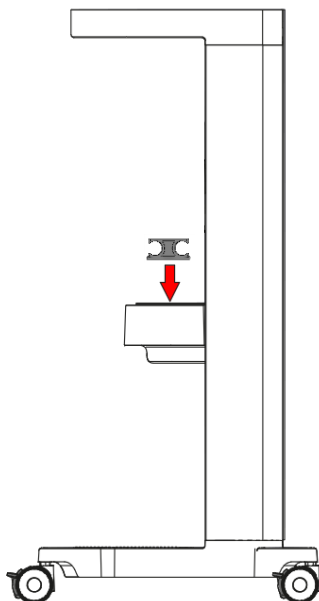

4. CLEANING & DISINFECTION

4.1. General cleaning

Clean the external surface of the device with a cloth and alcohol

- ❗ Clean the unit only with an alcohol-based (ethanol, isopropanol), colourless disinfectant.
- 🚫 Never use scouring powder or an abrasive sponge. It will damage its surface.
- ⚠️ Risk of contamination. Always clean and disinfect the bottle receptacle on the WATER Bottle Shelf System.

4.2. Water Line Cleaning & Disinfection

Keeping the device's water lines clean and disinfected is mandatory to prevent patient infection.

A regular daily cleaning using the EMS NIGHT CLEANER[®] agent cleans and disinfects the device's water lines, and helps to prevent the growth of biofilm and calcification in the long term.

Overnight cleaning: End of day

- ⚠️ Use only EMS NIGHT CLEANER[®] as a cleaning agent ¹. Other products may damage or not clean the unit, and cause patient intoxication. The NIGHT CLEANER[®] agent can remain active in the device's water lines for up to 1 week.

- 1 Place the NIGHT CLEANER[®] bottle onto the Cart

- ❗ Before cleaning, check that the liquid level is above the external black line of the bottle's neck.

- 2 ❗ Remove any other Bottles connected to the EMS AIRFLOW Prophylaxis Master or AIRFLOW One device

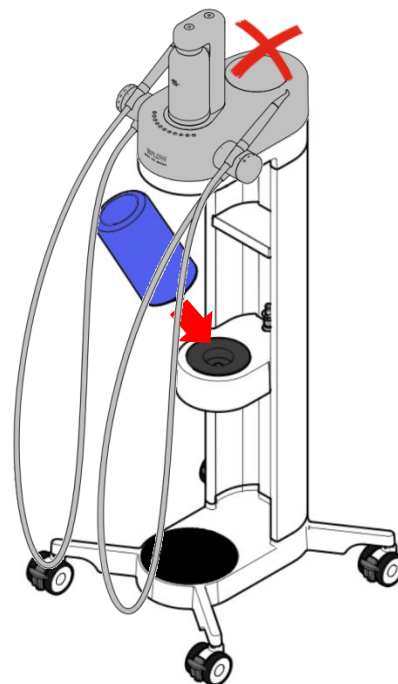

¹ Alternative long-term disinfection liquid, Alpro Bilpron, can be used.

AIRFLOW Prophylaxis Master - FT-229

- 3 According to eIFU FB-618 for your EMS AIRFLOW Prophylaxis Master follow the remaining cleaning steps:



Set water to 10
Turn the device ON

- ! Set both water regulators to 10 to ensure the flow of the cleaning agent.



Hold both cords over a sink
with CLIP+CLEAN

Contamination prevention:

- ! Do not make any contact between the sink and the cords.
- ! CLIP+CLEAN shall be reprocessed after each use. (Do not exceed 135°C).



Press the pedal once,
release, and then wait
1 minute

The white and blue countdown indicates remaining time.

Cleaning can be paused and resumed by pressing the pedal again.

Once completed, leave the NIGHT CLEANER® bottle on the device overnight.

AIRFLOW One - FT-230

- 3 According to eIFU FB-621 for your EMS AIRFLOW One follow the remaining cleaning steps:



Set water to 10
Turn the device ON

- ! Set water regulator to 10 to ensure the flow of the cleaning agent.



Hold cord over a sink

Contamination prevention:

- ! Do not make any contact between the sink and the cords.
- ! CLIP+CLEAN shall be reprocessed after each use. (Do not exceed 135°C).



Press the pedal during
30 seconds minimum

Cleaning can be paused and resumed by releasing and pressing the pedal again.

Once completed, leave the NIGHT CLEANER® bottle on the device overnight.

Rinsing: Each morning before the first patient

⚠️ Always perform a complete rinsing after overnight cleaning and before the first use. Residues of cleaner can cause patient intoxication.

- 1 Place a full WATER bottle onto the Cart
- 2 **!** Remove any other Bottles connected to the EMS AIRFLOW Prophylaxis Master or AIRFLOW One device

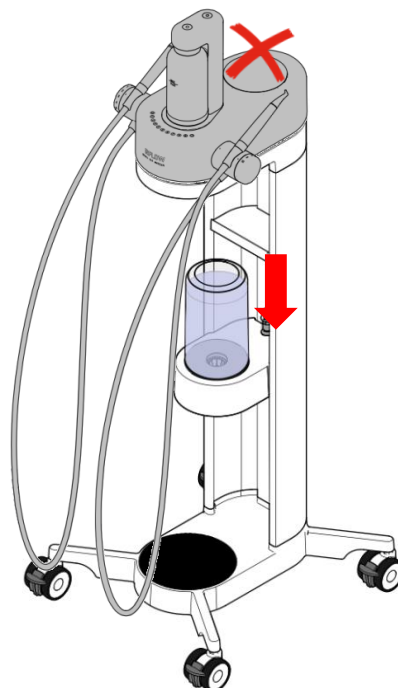

AIRFLOW Prophylaxis Master - FT-229

- 3 According to eIFU FB-618 for your EMS AIRFLOW Prophylaxis Master follow the remaining rinsing steps:



Set water to 10
Turn the device ON

! Set both water regulators to 10 to ensure optimal rinsing.



Hold both cords over a sink
with CLIP+CLEAN

Contamination prevention:
⚠️ Do not make any contact between the sink and the cords.



Press the pedal once,
release, and then wait
1 minute

The white and blue countdown indicates remaining time.

Cleaning can be paused and reset by pressing the pedal again.

- 7 **⚠️** Risk of ingestion of the cleaning agent.
 - After rinsing check that no more blue runs out of the cord. Otherwise, repeat the rinsing procedure.
 - During rinsing, a small quantity of cleaning agent flows back into the water bottle. Therefore rinse out the WATER bottle before treatment.

AIRFLOW One - FT-230

- 3 According to eIFU FB-621 for your EMS AIRFLOW One follow the remaining rinsing steps:



Set water to 10
Turn the device ON

- ! Set water regulator to 10 to ensure optimal rinsing.



Hold cord over a sink

- Contamination prevention:
! Do not make any contact between the sink and the cord.



Press the pedal during
30 seconds minimum

To rinse all the device's water line of the cleaning agent.

- 7 ! Risk of ingestion of the cleaning agent.

- After rinsing check that no more blue runs out of the cord. Otherwise, repeat the rinsing procedure.
- During rinsing, a small quantity of cleaning agent flows back into the water bottle. Therefore rinse out the WATER bottle before treatment.

5. MAINTENANCE & TROUBLESHOOTING

There is no preventative maintenance required for the AIRFLOW STATION+.

5.1. Troubleshooting



The device is whistling or making strange noises

Risk of bottle explosion.

First remove the bottle and disconnect the air supply. This symptom is generally caused by a problem to the pressure regulator (fault, low temperature), by a crack in the water bottle or incorrect input air pressure.

- 1° Stop using the water bottle shelf EL-656 immediately.
- 2° Check the bottle in use for crack or any damage and, if the case, replace it with a new one.
- 3° Check the input air pressure is between 4.5-7bars.
- 4° Check if EL-656 temperature is below 10°C (device too cold), wait for it to warm-up at ambient temperature and then reconnect to input air supply.
- 5° If checks 2-4 are not the source of the problem, and whistling noise persists, stop use of EL-656 and contact EMS aftersales service.

For other general troubleshooting, please refer to the eIFU of your EMS AIRFLOW Prophylaxis Master or AIRFLOW One device due to equivalence in the devices troubleshooting issues.

For any other technical issues please contact your local EMS service support team.

5.2. To contact EMS Service support

E.M.S. Electro Medical Systems S.A.

Ch. de la Vuarpillière 31
1260 Nyon – Switzerland

Phone: +41 (0) 22 99 44 700

Email: TSAV@ems-ch.com

6. SUSTAINABILITY

6.1. Disposal of waste parts



The device must not be discarded in domestic household waste. Should you wish to definitively dispose of the device, please comply with the regulations that apply in your country.



Keep the original packaging until the device is to be disposed of permanently. It can be used for shipping or storing.

6.2. Sustainable design



Most of the device and the packaging cardboards are recyclable.



Printed instructions respect the highest standards in sustainable development as My Climate neutral Imprimerie and FSC certification.

7. WARRANTY

Warranty is void if the WATER Bottle Shelf System of the device has been opened.













EMS and the distributor of this device accept no liability for direct or consequential injury or damage resulting from improper use, arising in particular through non-observance of the instructions for use, or improper preparation and maintenance.

EMS declines the responsibility for the safety of the device and declares the warranty null and void if service or repair is carried out by an unauthorized third party or if non-genuine spare parts are used.

8. TECHNICAL DESCRIPTION

Manufacturer	EMS ELECTRO MEDICAL SYSTEMS SA, CH-1260 Nyon, Switzerland
Models	AIRFLOW STATION+, product code DW-048A
Classification EU MDD 93/42/EEC	Medical Device Class I
Essential Performance	No Essential Performance in the meaning of the EU MDD 93/42
Operating mode	Continuous operation
Weight	20kg max. (full operating condition)
Dimensions	Height: 810 mm (without load), Width: 330 mm, Length: 360 mm
Operating conditions	Temperature: 10°C to 35°C Humidity: 30% to 75% Altitude: Max 2000m
Storage conditions	Temperature: -10°C to 30°C, no water inside Humidity: 95% not condensed
Transport conditions	Temperature: -29°C to 38°C, no water inside Humidity: 95% not condensed
Input fluids	Air: pressure 4.5-7 Bar, dry-only (humidity 1.032g/mq max.), oil filtered 0.1 mg/mq max., RECTUS 21KA connector type
Output fluids	Water: max. 90ml/min. for Airflow, max 70ml/min. for Piezon, with pressure 1.3 bar max. Air: same as input
Service life	Device: 7 years. No preventive maintenance required. WATER bottle: 3 years

8.1. Symbols

	General Warning
	Read the operation instructions
	Electronic instructions for use
	Mandatory action
	Do not do.
	Disposal of old electronic equipment (European Union & other countries with separate collection systems)
	Manufacturer
	Manufacturing date
	Serial number
	Catalog number / Product reference
	Input
	Compatible / Allowed / Connected
	NOT compatible / NOT allowed / NOT connected



HEADQUARTERS



CH

NYON, SWITZERLAND E.M.S. ELECTRO MEDICAL SYSTEMS S.A.

Ch. de la Vuarpillièrre 31
CH-1260 Nyon
Tel. +41 22 99 44 700
Fax +41 22 99 44 701
www.ems-dental.com/en/contact
www.ems-dental.com



WORLDWIDE EMS AFFILIATES

DE

MUNICH, GERMANY EMS ELECTRO MEDICAL SYSTEMS GMBH

Schatzbogen, 86
D-81829 Munich
Tel. +49 89 42 71 61 0
Fax +49 89 42 71 61 60
info@ems-ch.de

US

DALLAS, USA EMS ELECTRO MEDICAL SYSTEMS

Corporation
11886 Greenville Avenue, #120
Dallas, TX 75243
Tel. +1 972 690 83 82
Fax +1 972 690 89 81
info@ems-na.com

ES

MADRID, SPAIN EMS ELECTRO MEDICAL SYSTEMS ESPAÑA SLU

c/ Tomás Bretón, 50-52, 2ª planta
E-28045 Madrid
Tel. +34 91 528 99 89
info@ems-espana.com

CN

SHANGHAI, CHINA

医迈斯电子医疗系统贸易（上海）有限公司
E.M.S. ELECTRO MEDICAL SYSTEMS TRADING (SHANGHAI) CO., LTD.
24A, No 379, Jin Sui Mansion
Pudong Nan Road
Shanghai 200120
Tel. +862133632323
emschina@ems-ch.com

FR

FONCINE, FRANCE EMS ELECTRO MEDICAL SYSTEMS FRANCE SARL

32, Route de Pontarlier
FR-39460 Foncine-le-Haut
Tel. +33 3 84 51 90 01
Fax +33 3 84 51 94 00
info@ems-france.fr

JP

TOKYO, JAPAN E.M.S. JAPAN BRANCH OFFICE

501, 73 Kanda Neribeicho Chiyoda-ku
Tokyo 101-0022 – Japan
Phone : +81 (0) 3 3278 0375
Fax : +81 (0) 3 3278 0376
emsjapan@ems-ch.com

IT

MILAN, ITALY EMS ITALIA S.R.L.

Via Faravelli, 5
I-20149 Milan
Tel. +39 02 3453 8111
Fax +39 02 3453 2778
dental@ems-italia.it